

TRANSITION RAMP

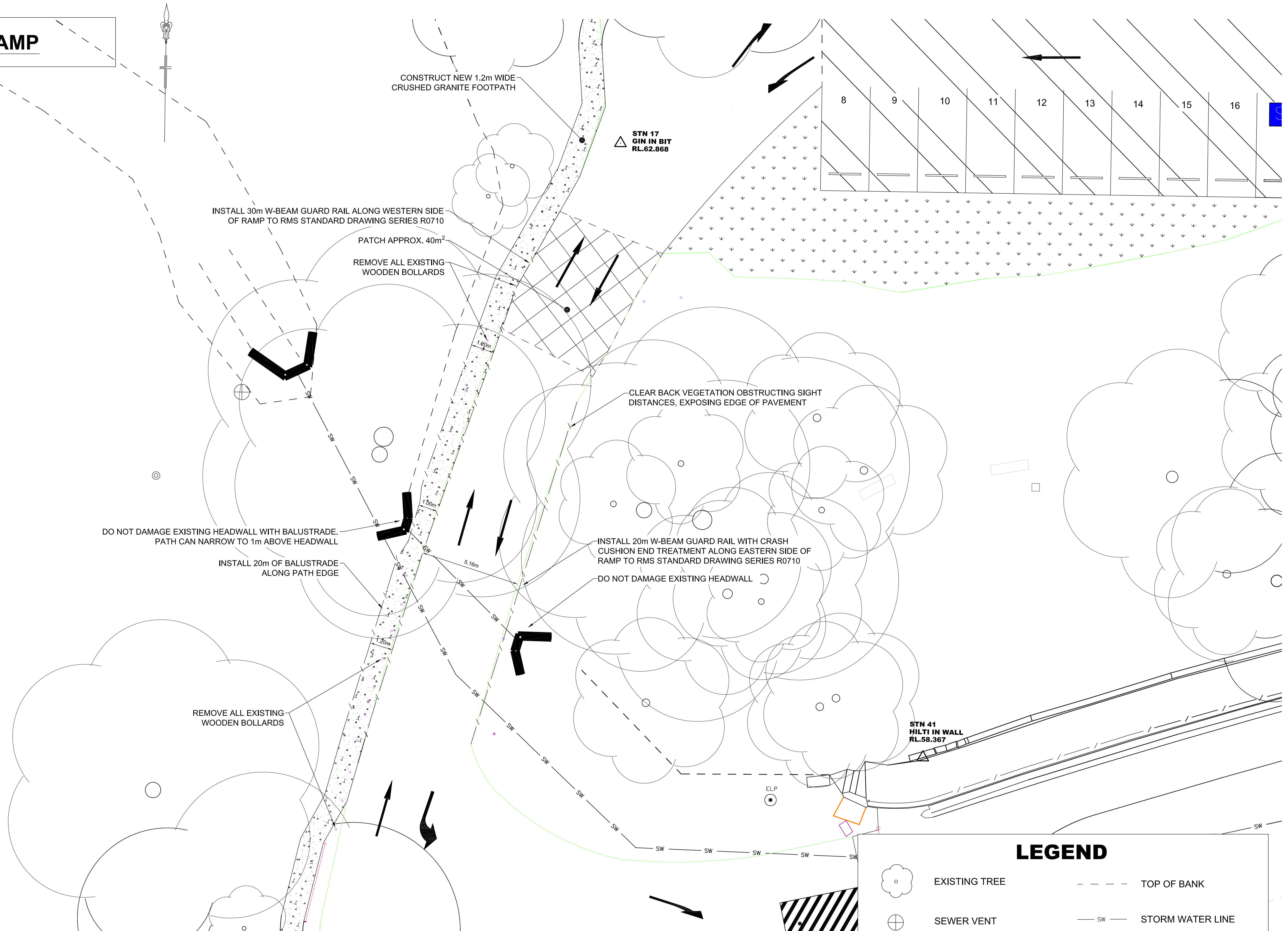

NOTES:

1. ASPHALT PAVEMENT IS TO BE RESURFACED
2. DAMAGED BOLLARDS ARE TO BE REPLACED/REPAIRED
3. DAMAGED SIGNS ARE TO BE REPLACED/REPAIRED
4. ALL DIMENSIONS ARE IN METRES UNLESS OTHERWISE STATED
5. VEGETATION OBSTRUCTING SIGHT DISTANCES AT THE ENTRY/EXIT DRIVEWAY AND RAMP CONNECTING UPPER AND LOWER CAR PARKS IS TO BE CLEARED
6. UPPER CARPARK LIGHTING IS TO BE IMPROVED

LEGEND

-  EXISTING TREE
-  TOP OF BANK
-  SEWER VENT
-  STORM WATER LINE
-  SEWER MANHOLE
-  RESHEET PAVEMENT

PREPARED BY:	SCALE:	SIZE:	ALL DIMENSIONS IN MILLIMETRES UNLESS NOTED OTHERWISE				
DESIGN AND DRAINAGE TEAM LEADER (DATE)	1:100	A1	CO-ORDS. ISG DATUM AHD				
ENDORSED BY:	SURVEYED	J.TENHOEDT	23/11/2015				
DESIGN AND INFRASTRUCTURE DELIVERY MANAGER (DATE)	DRAWN	M.NATOLI	25/11/2019				
APPROVED FOR CONSTRUCTION BY:	DESIGNED	S.HANDO	07/09/2020				
ENGINEER P. COLLINGS (DATE)	CHECKED	D.NGUYEN	07/09/2020				
AMENDMENTS	BY	DATE					

WILLOUGHBY CITY COUNCIL
ARTARMON RESERVE, ARTARMON
CARPARK RECONSTRUCTION
SITE LAYOUT - TRANSITION RAMP



No. OF SHEETS	SHEET No.
4	2
PLAN NUMBER	
P2986	